







# Anlage 2

## Legende

-  Baumbestand
-  Zu fallenden Bäume
-  Gehölzflächen schneiden
-  Abbruch bestehende Einfeldhalle
-  Neubau Zweifeldschulsporthalle
-  Abbruch Treppenanlage, Roter Platz, Stützmauern  
Asphalt Belag, Erdaushub

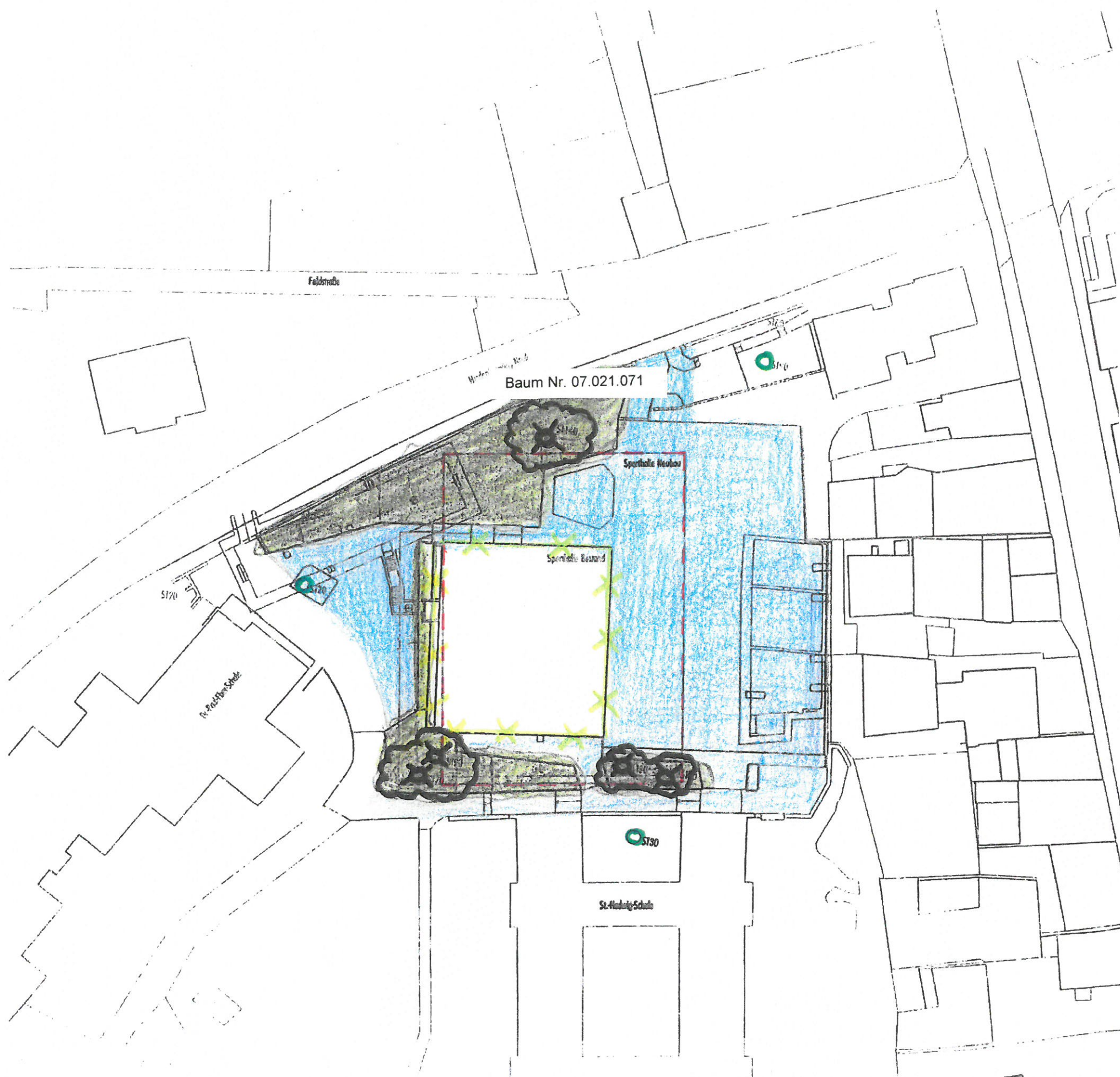

Zweifeldschulsporthalle mit Ganztagsbetreuung  
im Deusterpark, Kitzingen

Lageplan Abbruchkonzept

08.07.2016

M 1: 533

H.Icli